

RJ1 Code : RJ1035 - RJ1060 - RJ1120

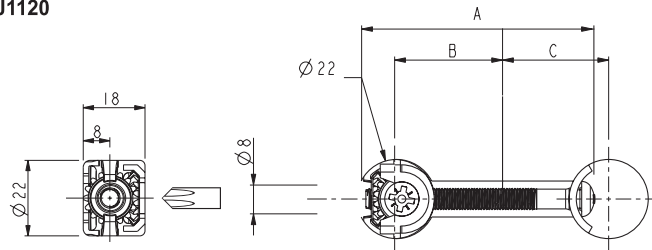

	35mm Bolt	60mm Bolt	120mm Bolt
A	17mm	29mm	59mm
B	17mm	29mm	59mm
C	17mm	29mm	59mm

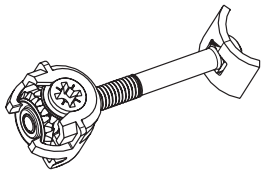
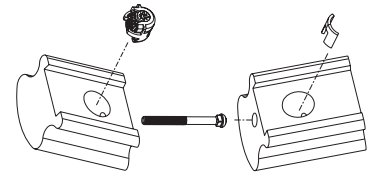

ATTENTION! If using an Electric or Battery Drill apply clutch setting when installing Rapidjoint Connectors

RJ1 M6 All Thread & Dowell Code : RJ1D

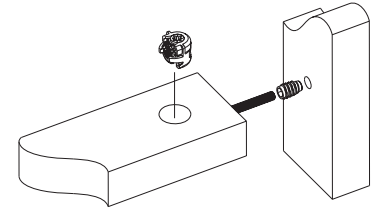
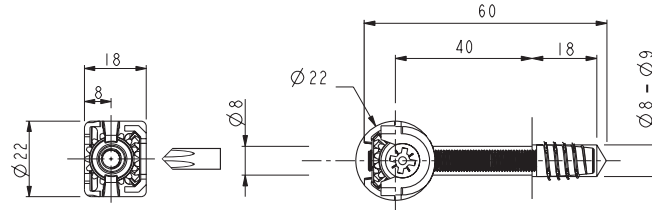
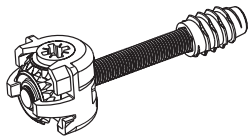

NOTE: Apply lubrication to external thread when inserting dowell

RJ1 M6 Mitre-Bolt Code : RJ512A

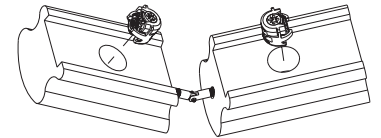
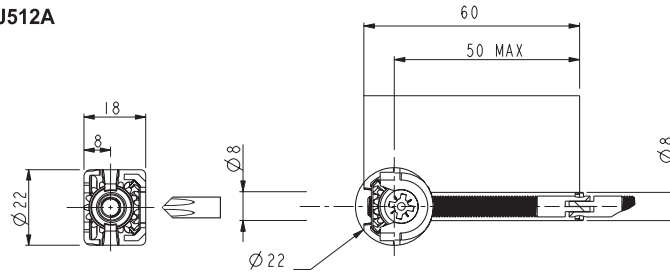
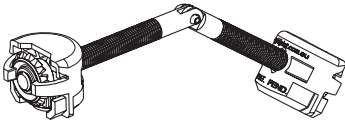

RJ2 Pre-Install Code : RJ2

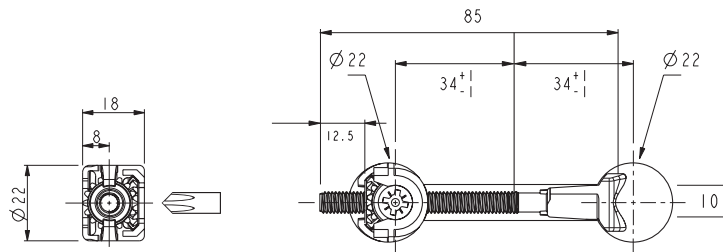
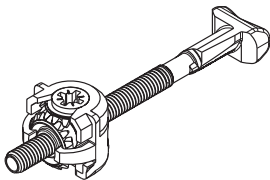

Screw-Driver:
Anti-Clockwise to Deploy then Reverse (Clockwise) to Clamp once head rotates into circular recess

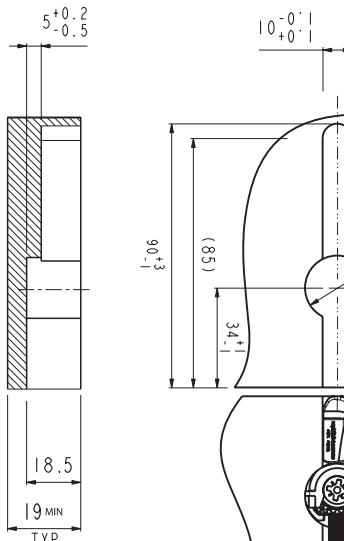
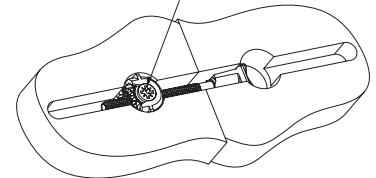

Stage 1

Stage 2

Stage 3

Stage 4

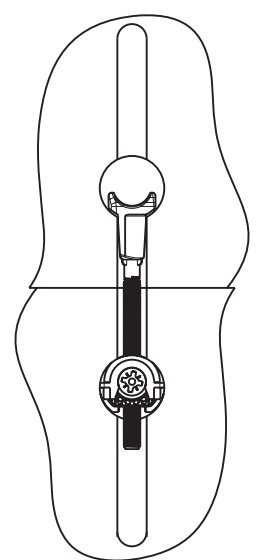
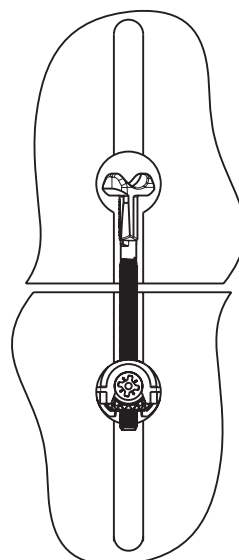
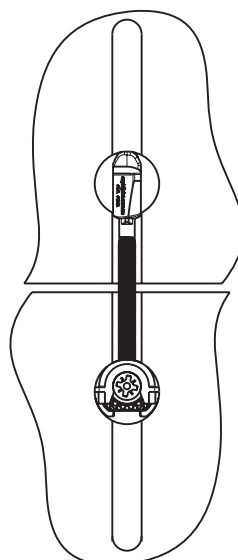
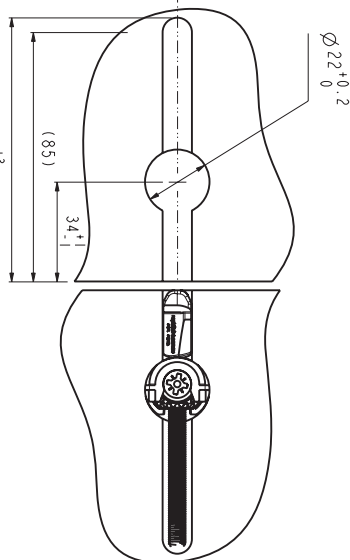

Turn clutch on. Place drill in reverse position.

Place drill with desired bit into recess and reverse until head reaches opposing cavity.

Place drill in forward position and begin tightening.

Check join for accuracy and complete tightening.



Offering Superior Speed, Quality and Strength, Rapidjoint is the Ultimate in Joinery Connectors